

Eden Township

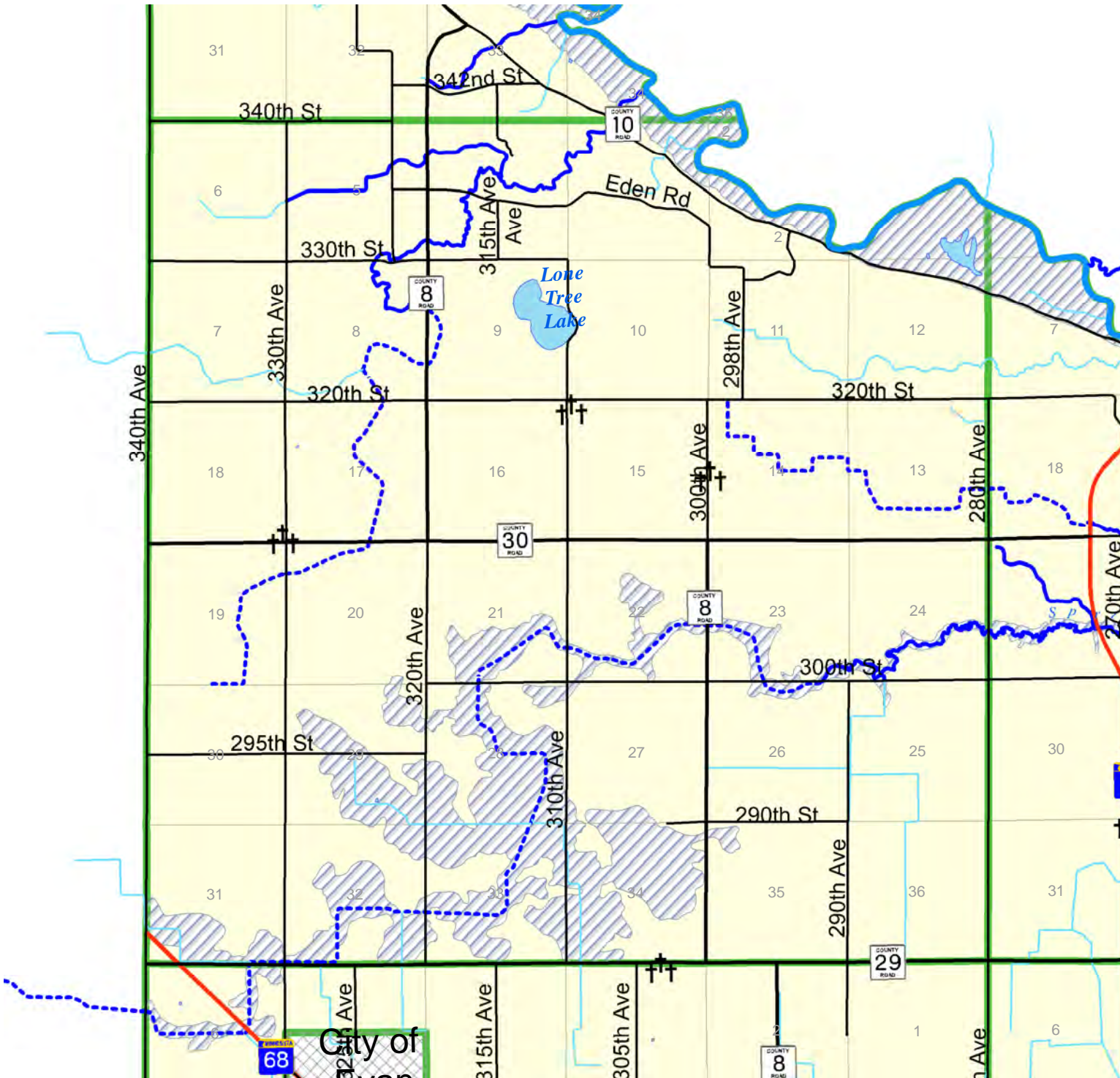

- | Zoning | | Water | |
|-------------------|---------------|-------|-----------------------------|
| | Agriculture 1 | | Public Water Watercourse* |
| | Business 1 | | Public Ditch* |
| | Business 2 | | *Protected Waters/Shoreland |
| | Industrial 1 | | Other Watercourse |
| | Industrial 2 | | Lakes |
| | Residential 1 | | Railroad |
| | Floodplain | | Airports |
| Other Land | | | |
| | Parks | | Villages |
| | Golf Course | | City |
| | WMA | | Township |
| | Sections | | Church |
| | US Hwy | | Cemetery |
| | State Hwy | | |
| | County Rd | | |
| | Township Rd | | |

1 in = 1 miles
1 in = 5,279 feet

This information is to be used for reference purposes only. Brown County does not guarantee accuracy of the material contained herein and is not responsible for misuse or misinterpretation.

Map Created on 06-02-2011 by Brown County.
Updated: 12-30-13

Data Sources:
Townships - Brown County
Sections - Brown County
Roads - Brown County
Water Features - MN DNR
WMAs - MN DNR
Zoning - Brown County
Parks - Brown County
Churches, Cemeteries - Brown County

